

Proudly Providing Services for 70 Years



Project Highlights

City of Pontiac Water Distribution System – Valve Location, Inventory, Inspection & Exercising Program

Johnson & Anderson, Inc. was recently retained by the Oakland County Water Resources Commission (OCWRC) to provide professional engineering services related to locating and assessing the condition of the larger valves in the City of Pontiac Water Distribution System. The project consists of locating and performing a condition assessment for approximately 142 valves larger than 12” diameter in the City that are being operated by staff from OCWRC.



Valves were located by the project team using existing distribution system records from the City of Pontiac and Oakland County, survey, and available GIS. Standardized forms were developed on which to record the information related to each valve. Using GIS information and mapping, J&A developed a survey sequence strategy which will result in an efficient plan for conducting the inspections. A Valve Condition and Operability Report, which includes recommendations and associated cost estimates will be provided to the OCWRC and City of Pontiac by the end of May.

City of Muskegon Cemetery Management System for Restlawn Cemetery

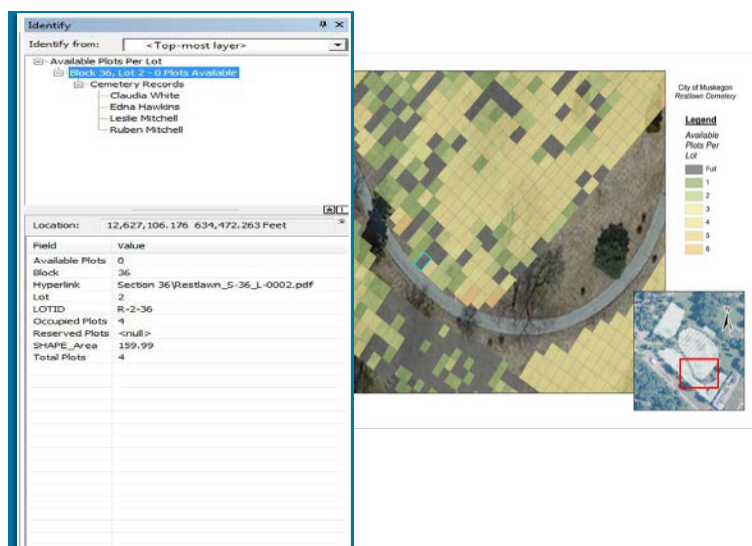

Johnson & Anderson was contracted by the City of Muskegon to develop a Cemetery Management System for Restlawn Cemetery. The cemetery management system was based on integrating the legacy cemetery records into an ESRI Geographic Information System (GIS) map. The goal was to improve and enhance the efficacy of the City’s current cemetery record system. Restlawn Cemetery was established in 1924 and consists of 13 acres with over 6,700 plots.

J&A staff collected field survey information related to lot and block locations and road centerlines. Field survey data was collected using GPS (global positioning system) equipment utilizing State Plane coordinates. Using collected field survey data, J&A staff created layers of the cemetery showing lot and block locations. Utilizing ArcMap, an ESRI software, existing cemetery maps were “rubber sheeted” to assist in lot and block reconstruction. Lot and block locations were geographically positioned by using survey data and best fit techniques.

J&A digitized the existing paper cemetery documents into electronic files. Existing paper documents were scanned and indexed. Digitized record documents were uploaded into a database and linked to the Restlawn Cemetery GIS. Links to open related scanned documents were attached to features in GIS for simple retrieval.

J&A linked layers in the Cemetery GIS to the City’s existing burial database. The database included: Cemetery Code, First and Last Name, Grave, Lot, Block, and death information, as available. The City now has the ability to add or edit burial information and print location maps. The interface also allowed the City to perform plot searches to retrieve burial and plot information. A color legend was developed to graphically show lot status as follows: occupied, reserved, for sale, or unusable. J&A developed and implemented a web-based user interface for public use for the purpose of a cemetery burial search. Search and printing tools were developed to assist in grave inquiries.

Recently Awarded Projects

- Muskegon County Drain Commissioner – Wolf Lake Pump Station Evaluation
- City of Bay City – Professional Engineering Services
- City of Bangor – Capital Improvement Planning
- City of Southfield-Liquiforce – Webster Avenue / Rock Creek Drive Watermain Lining
- OCWRC Paddock Street Watermain Replacement

Meet our newest J&A Team Member



Mark Schobert, P.E., Senior Project Engineer, has joined Johnson & Anderson, Inc. and brings over 24 years of experience, specializing in Civil Engineering, Asset Management and Capital Improvement Planning, Sanitary Sewer Rehabilitation, and Project Management.

Mark holds a Bachelor of Science in Civil Engineering from Valparaiso University. He has previously served as Project Manager for Metro Consulting Associates, Inc. and Wade Trim.

We are very excited to have Mark on our team. For your asset management and sewer rehabilitation needs, please contact Mark at: 248.681.7800, mschobert@ja-engr.com.

J&A is expanding!

J&A is proud to announce we have recently opened a new office in Flint, located at 2387 S. Linden Road, Suite B-142, in an effort to better serve our existing Bay, Genesee, and Lapeer County clients.

Contact us today to find out how we can assist you.